

GENERAL DETAILS – CONCRETE CARRIAGEWAY

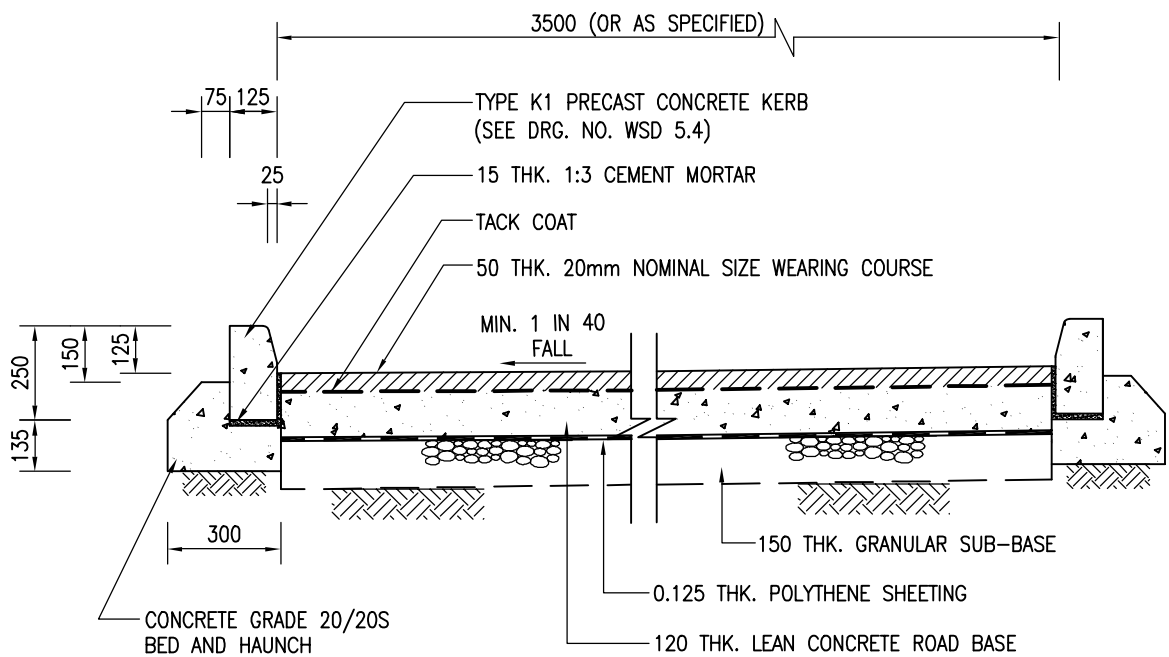

GENERAL DETAILS – FLEXIBLE CARRIAGEWAY

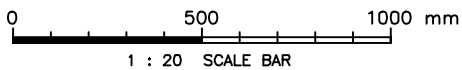

Cad Ref. : WSD050101-B.dwg

B	RE-FORMATTED TO CSWP	W.K. CHIU	14/11/03
A	GENERAL REVISION	W.K. CHIU	26/6/00
REF.	REVISION	APPROVED	DATE

ACCESS ROAD –
TYPICAL SECTIONS AND
JOINT DETAILS



水務署
Water Supplies Department

APPROVED	G.C. LEE AD/NW	DRAWING NO. WSD 5.1B (SHEET 1 OF 3)	CSWP
DATE	9/6/92		
SCALE	1 : 20		

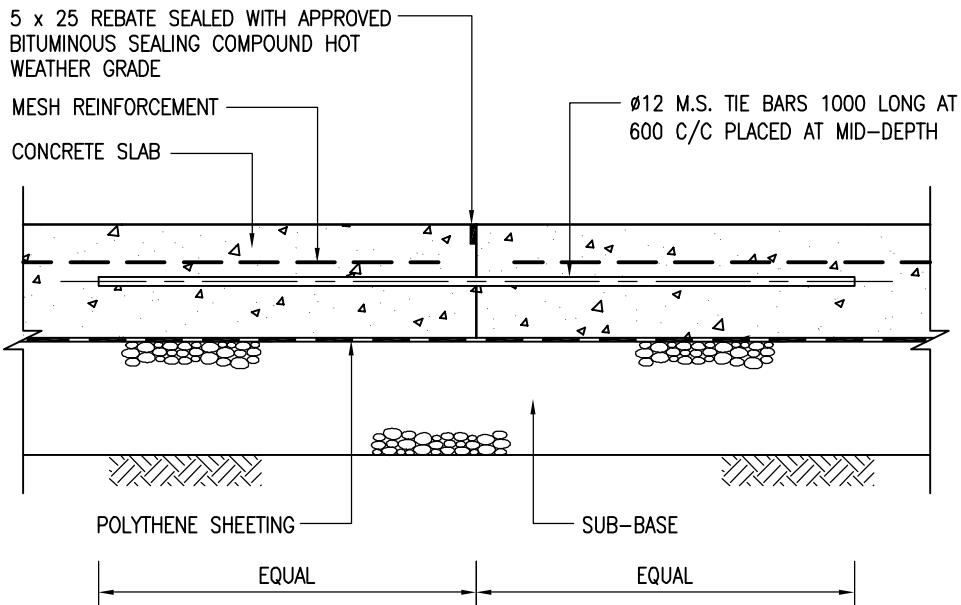

LONGITUDINAL JOINT

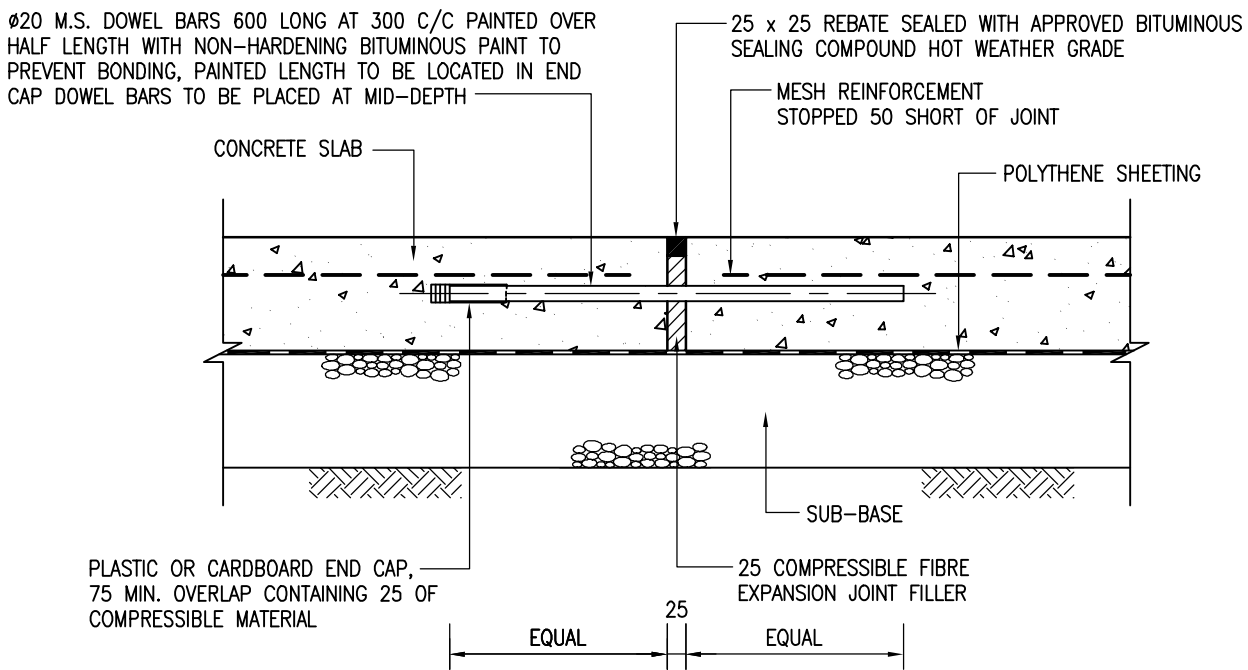

EXPANSION JOINT

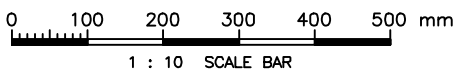

Cad Ref. : WSD050102-B.dwg

ACCESS ROAD -
TYPICAL SECTIONS AND
JOINT DETAILS



水務署
Water Supplies Department

APPROVED

G.C. LEE
AD/NW

DATE

9/6/92

SCALE

1 : 10

DRAWING NO.

WSD 5.1B

(SHEET 2 OF 3)

CSWP

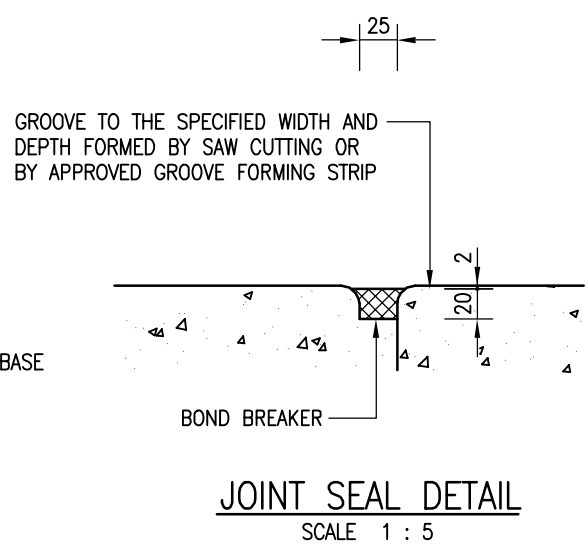
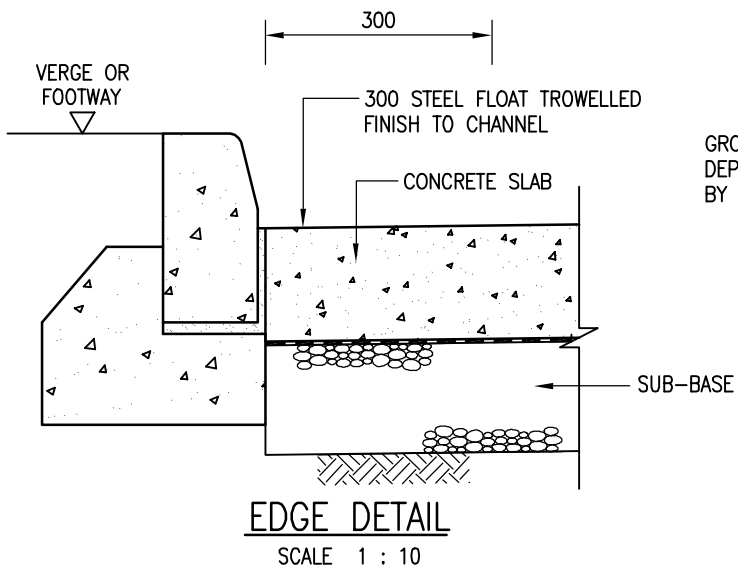
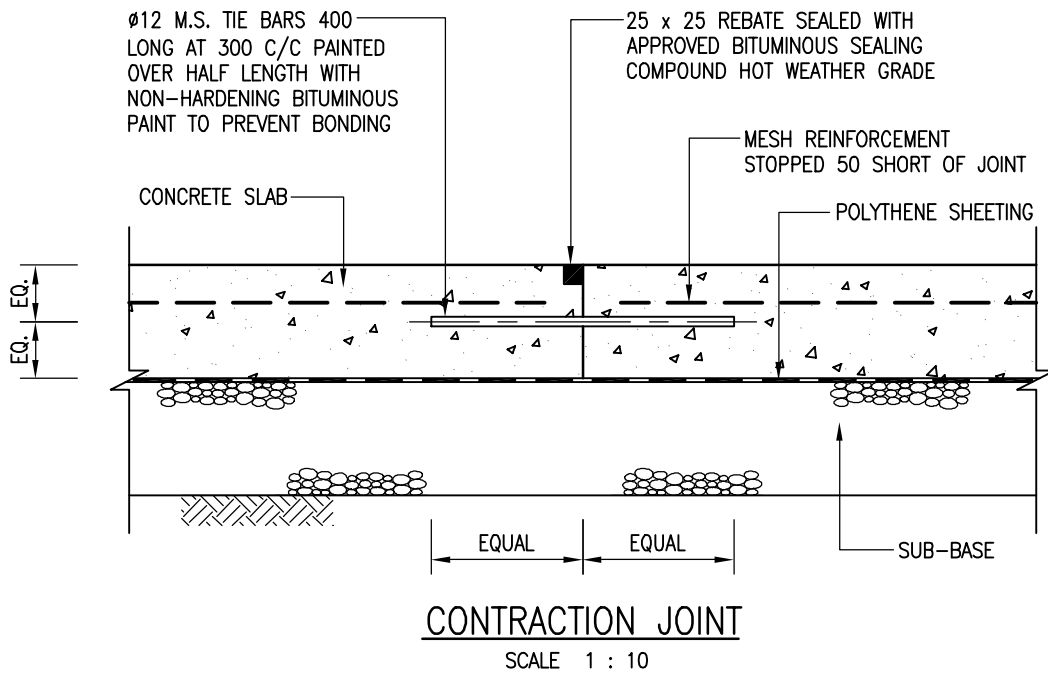

- NOTES :
1. ALL DIMENSIONS ARE IN MILLIMETRES.
 2. MAXIMUM SPACING OF JOINTS IS 25m, EVERY THIRD JOINT TO BE AN EXPANSION JOINT.
 3. LONGITUDINAL JOINTS ARE TO BE PROVIDED TO LIMIT SLAB WIDTH TO LESS THAN 4.5m.
 4. EXPANSION JOINTS MAY BE REPLACED BY CONTRACTION JOINTS IF ROAD IS CONSTRUCTED DURING THE SUMMER.
 5. OVERLAP TO MESH REINFORCEMENT TO BE 450 MIN.

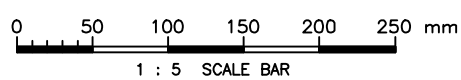
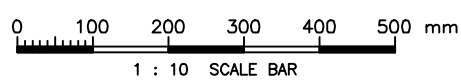

Cad Ref. : WSD050103-B.dwg

<p>ACCESS ROAD – TYPICAL SECTIONS AND JOINT DETAILS</p>	 <p>水務署 Water Supplies Department</p>		<p>DRAWING NO. WSD 5.1B (SHEET 3 OF 3)</p>	<p>CSWP</p>
	<p>APPROVED</p>	<p>G.C. LEE AD/NW</p>		
	<p>DATE</p>	<p>9/6/92</p>		
	<p>SCALE</p>	<p>1 : 10 OR AS SHOWN</p>		